

## Fact Sheet for Partner Universities 2024

<b>Name of the University</b>	Hochschule Luzern <b>Lucerne University of Applied Sciences and Art</b>
<b>School / Faculty</b>	Hochschule Luzern - Informatik <b>School of Computer Science and Information Technology</b>
Postal Address	International Office Campus Zug-Rotkreuz Suurstoffi 1 CH-6343 Rotkreuz
Website	<a href="https://www.hslu.ch/en/lucerne-school-of-information-technology/international/">https://www.hslu.ch/en/lucerne-school-of-information-technology/international/</a>
Email Address	<a href="mailto:international.it@hslu.ch">international.it@hslu.ch</a>
Erasmus Code	CH LUZERN14
Information for Incoming Exchange Students	<a href="https://www.hslu.ch/en/lucerne-school-of-information-technology/international/incoming/">https://www.hslu.ch/en/lucerne-school-of-information-technology/international/incoming/</a>
<b>Contact Persons</b>	
International Relations Co-Heads International Office	Daniela Stoll, <a href="mailto:daniela.stoll@hslu.ch">daniela.stoll@hslu.ch</a> Selma Crosby, <a href="mailto:selma.crosby@hslu.ch">selma.crosby@hslu.ch</a>
Exchange Program Coordinators	Salome Lütolf & Annik Scholzen, <a href="mailto:international.it@hslu.ch">international.it@hslu.ch</a>

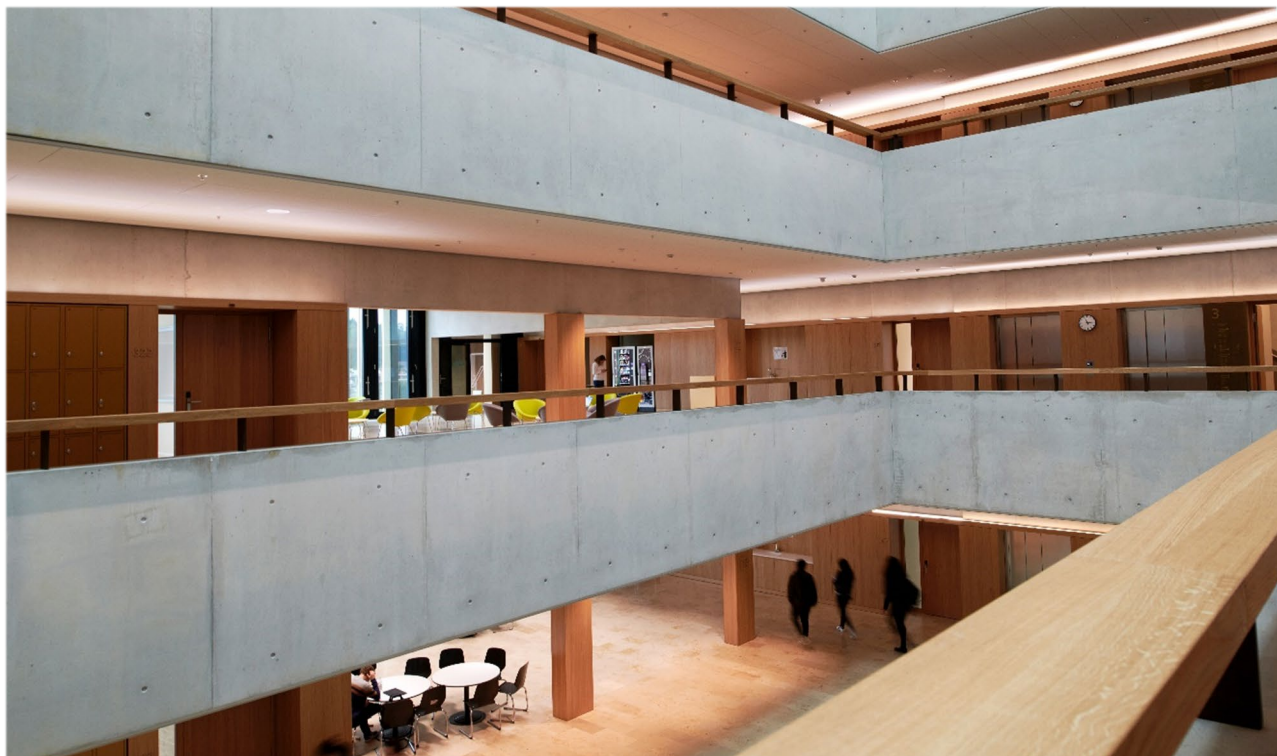

## Important Dates

Up to date Semester dates can be found on our [website](#)

### Spring Semester 2024

#### **Get started in Lucerne Workshops** (mandatory)

Part One: 16 December 2023, online via Zoom

Part Two: 17 February 2024, on-site at the Campus Zug-Rotkreuz (registration and more information [here](#))

[Introductory weeks](#) for new incoming students: two weeks before the semester starts (5 February 2024 - 17 February 2024). You can choose between intensive language courses or courses in your study field. For non-German speaking incoming students we highly recommend attending the German as a foreign language course.

Semester dates: **19 February 2024 - 6 July 2024**

Exam period: 17 June 2024 - 6 July 2024

Students are expected to be in Switzerland for the exam period.

Public Holidays during the semester:

- 29 March 2024 (Good Friday)
- 1 April 2024 (Easter Monday)
- 9 May 2024 (Ascension Day)
- 20 May 2024 (Whit Monday)
- 30 May 2024 (Corpus Christi)

### Fall Semester 2024

#### **Get started in Lucerne Workshops** (mandatory)

Part One: 6 June 2024, online via Zoom

Part Two: 14 September 2024, on-site at the Campus Zug-Rotkreuz (registration and more information [here](#))

[Introductory weeks](#) for new incoming students: two weeks before the semester starts (2 September 2024 - 13 September 2024). You can choose between intensive language courses or courses in your study field. For non-German speaking incoming students we highly recommend attending the German as a foreign language course.

Semester dates: **16 September 2024 – beginning of February 2025**

Exam period: mid-January 2025 - beginning of February 2025

Students are expected to be in Switzerland for the exam period.

Public Holidays during the semester:

- 1 November 2024 (All Saints' Day)
- 8 Dezember 2024 (Immaculate Conception)

### **Nomination & Application Deadlines**

Nomination by [E-mail](#): **15 October**

Application online: 31 October for the following Spring Semester

Nomination by [E-mail](#): **15 April**

Application online: 30 April for the following Fall Semester

After nomination of the student, they will receive access to our online application tool (Mobility Online) to complete their application.

## Academic Information

### **Courses for Incoming Exchange Students**

The course offer can be found on our [website](#) for incoming students.

### **Grading System**

From 1 – 6 (6 is the best, 1 is the lowest grade. Passing grade is 4)

### **ECTS System**

The Lucerne University of Applied Sciences and Arts fully subscribes to the ECTS System and allocates ECTS credits to all undergraduate and postgraduate programs. In line with ECTS requirements, 60 credits measure the workload of a full-time student during one academic year.

<b>Full-time Study Load</b>	Maximum of 30 ECTS per semester (minimum 18 ECTS). One ECTS points equals to 30 hours of work (lessons, self-study, homework, etc.).
<b>Language Requirements</b>	Proof of English Proficiency at least B2 level (if applying for courses taught in English and if not mother tongue) or Proof of German Proficiency at least B2 level (if applying for courses taught in German and if not mother tongue)
<b>Admission Requirements</b>	Have completed at least two semesters of study at the home university before mobility, proof of language proficiency, recommended GPA 2.75 or above
<b>Language Courses</b>	The University offers a range of language courses in its <a href="#">language centre</a> .
<b>Course Registration</b>	The exchange program coordinator of the Lucerne University of Applied Sciences and Arts will do the course registration for you according to your predefined learning agreement, except for language courses. For those you must enroll yourself (information follows after application).
<b>Transcripts of Records</b>	Transcripts are generally available few weeks after the final exams. The exchange program coordinator will send the official transcript to the student's home institution and a copy to the student by email.

#### Further Information for International Students

<b>General Information for Incoming Students</b>	Information on courses available in English, student guide, application process can be found on: <a href="https://www.hslu.ch/en/lucerne-school-of-information-technology/international/incoming/">https://www.hslu.ch/en/lucerne-school-of-information-technology/international/incoming/</a>
<b>Accommodation</b>	Please find on Campus accommodation offer <a href="#">here</a> . <b>Room bookings</b> must be made via our online application tool (Mobility Online). Booking period for spring semesters starts on <b>15 November</b> for students from partner universities. Freemover students can book as of 1 <sup>st</sup> December. Booking period for fall semesters start on <b>15 May</b> for students from partner universities. Freemover students can book as of 1 <sup>st</sup> June.
<b>Buddy Program</b>	The buddy program is run by <a href="#">ESN Luzern</a> (Erasmus student network). Incoming students can sign up for a buddy during application process.
<b>Visa Information</b>	<a href="https://www.hslu.ch/en/lucerne-university-of-applied-sciences-and-arts/campus/living-in-lucerne/einreise/">https://www.hslu.ch/en/lucerne-university-of-applied-sciences-and-arts/campus/living-in-lucerne/einreise/</a> Please contact our International Office, we provide more information in case you need a visa to enter Switzerland.
<b>COVID-19</b>	<a href="#">Current Information</a> and <a href="#">FAQ</a> (at the moment no restrictions in place)

